

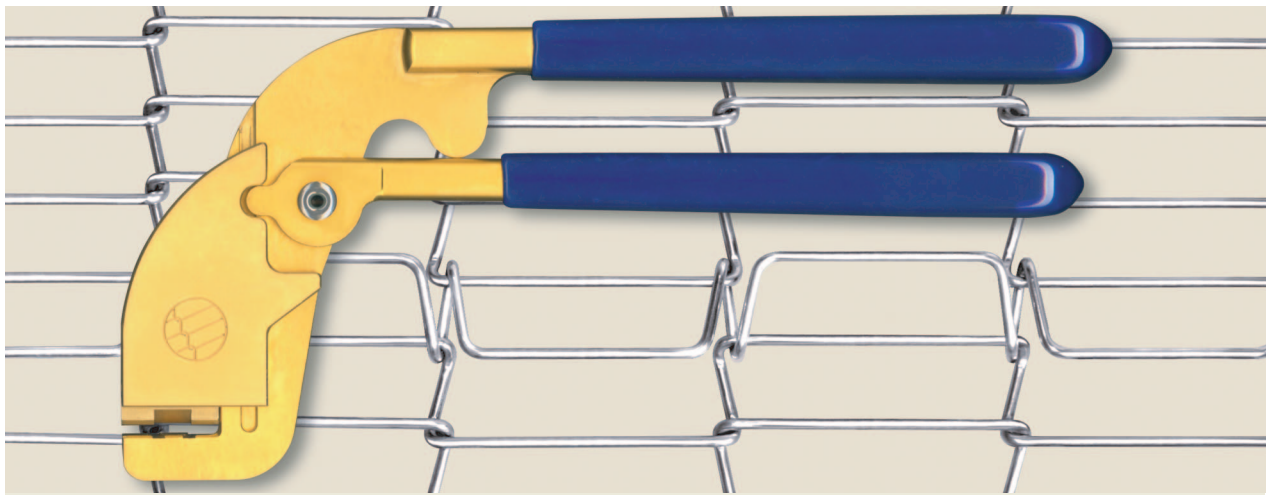

***Belt splicing MADE EASY!***



## ***Belt Splicing Instructions***

***\*EZSplice Gives You  
Longer Belt Life Too!***

	<b>WARNING!</b>
Disconnect and lock out conveyor power before splicing belts!	

U.S. Patent number 4,754,871  
©MARCH-2004 Wire Belt Company of America

*\*Ask our Technical Services how  
EZSplice can increase your belt life*

*An ISO 9001:2000 registered company*

**Step 1**

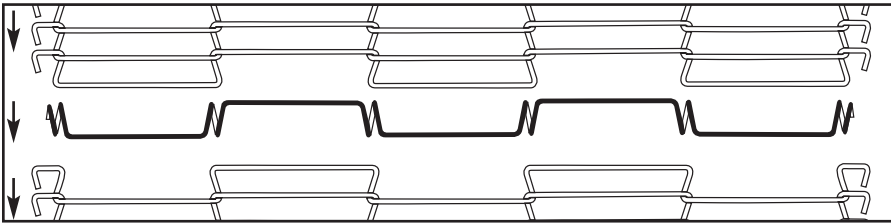

Place the EZSplice strand between the two ends of the belt to be joined, matching and aligning the spaces of the strand with the spaces of the belt. Make sure that the cut end of the EZSplice strand is on the bottom. See illustration A.

**Correct**

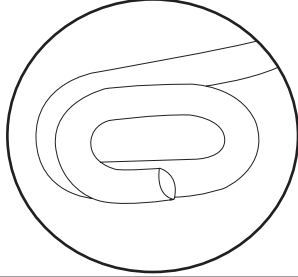

**(A)**

**Incorrect**



**Tools You Will Need:**

- Safety Glasses**
- EZSplice Strand**
- EZSplice Profiling Pliers**

**Step 2**

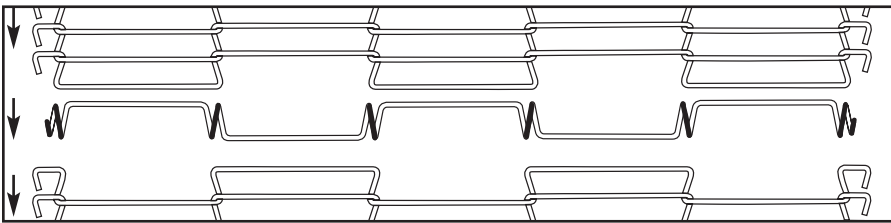

Once both ends of the belt are aligned with the spaces in the EZSplice strand, turn the EZSplice strand over and hook both end loops in as shown below.

Hook end loop in place

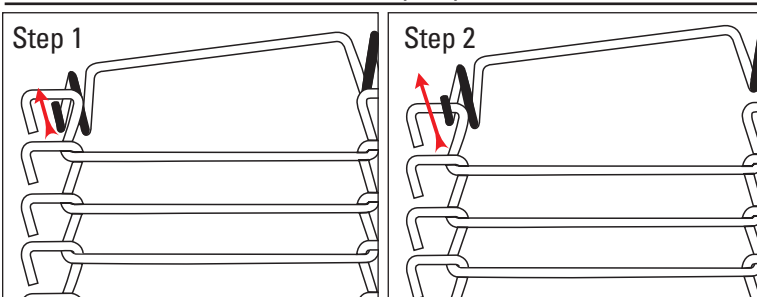

Hook end loop in place. See the illustration Step1 and Step 2 to the left.

Repeat opposite end

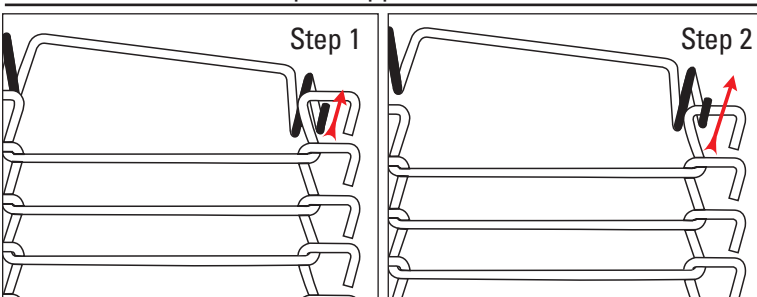

Repeat opposite end. See the illustration Step1 and Step 2 to the left.

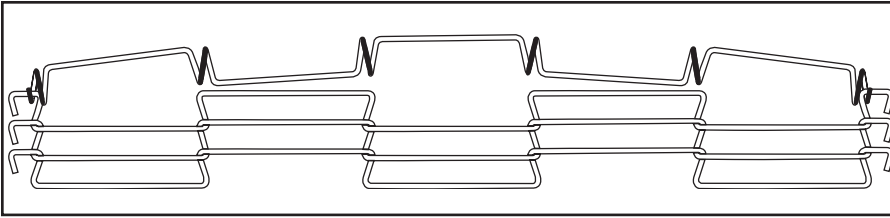
**Step 3**

Now that you have both endloops hooked, turn the EZSplice strand 180° or 1/2 turn.

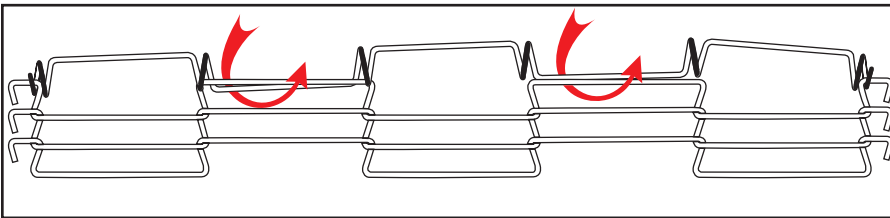
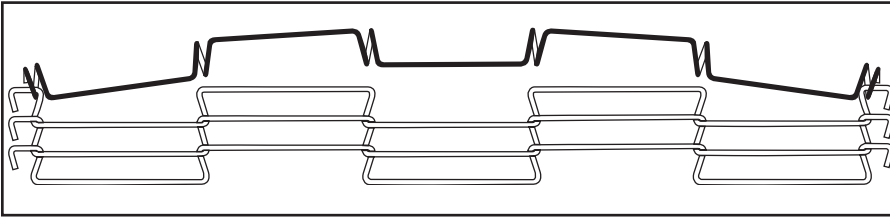

Turn and insert the second space of the EZSplice strand through the second space of the belt to be spliced and repeat every other space until the end of the belt is reached.

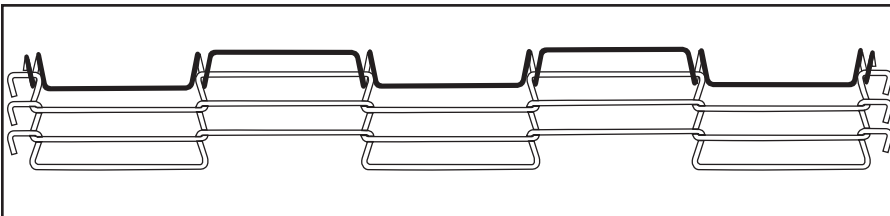

Now the bottom half of the joint is completed

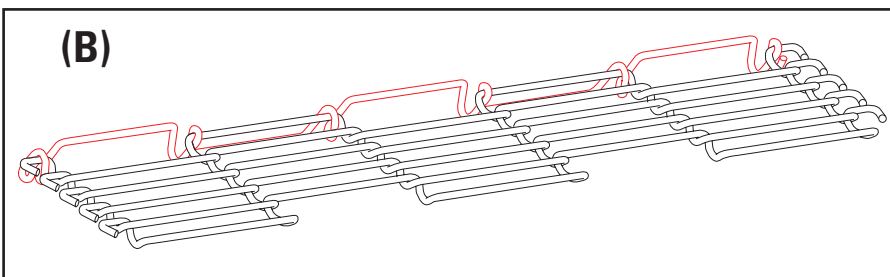
**Step 4**
**(B)**

Once the bottom half is all locked into the appropriate spaces across the width of the belt, turn the EZSplice strand about 1/4 turn or about 90° up as shown to the right. See illustration B.

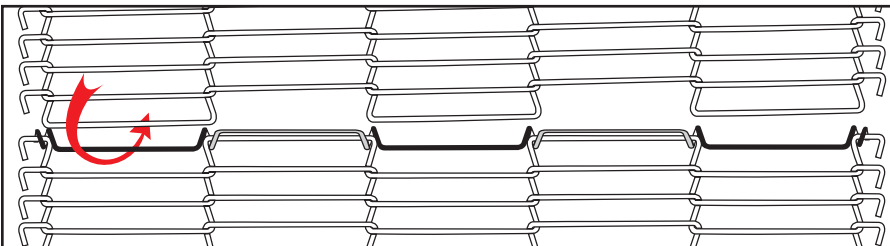

Take the top half of belt and hook the first space over and through the first space of the EZSplice.

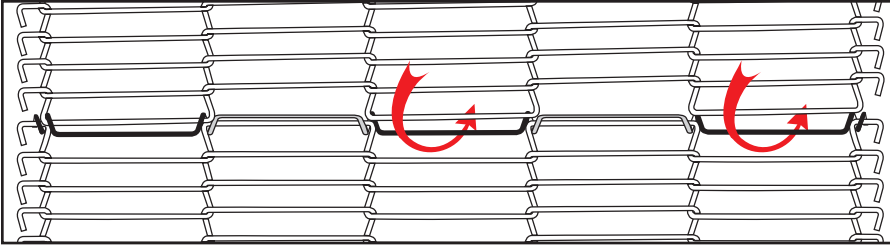
**Step 4 Continued**

Then repeat every other space until the end of the belt is reached.

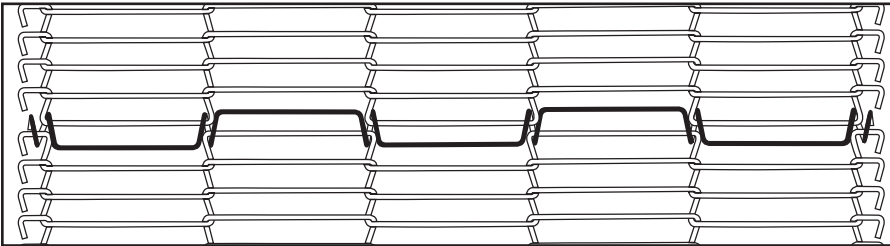

Now that the splice is all in place, follow Step 5 and Step 6 to "Lock" your EZSplice strand in place.

**Step 5 – Inserting the bit**

Insert the beveled edge of the bit into the jaw slot pushing in with your index finger until you hear a click indicating that the bit is locked in place. Make sure to use the correct bit.

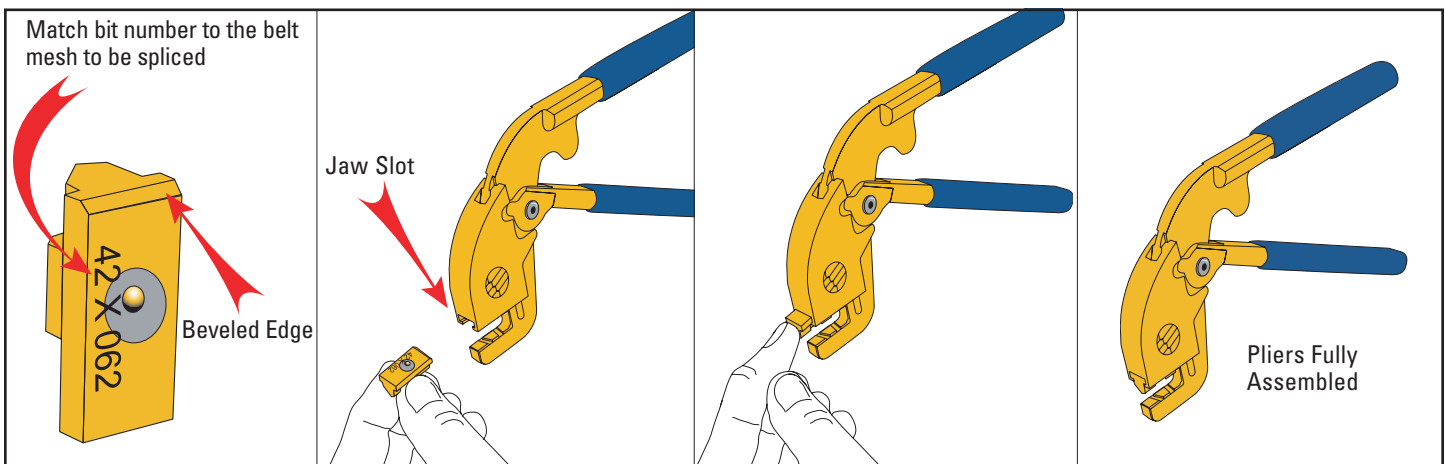

### Step 6 – Crimping

Starting in the center of the belt to be crimped, insert the lower jaw of the profiling pliers into the splice strand. Match the splice Z-bend up with the corresponding groove on the lower jaw of the profiling pliers and crimp down. Moving outward insert the lower jaw into the next splicing bend again matching the the splice Z-bend up with the corresponding groove on the lower jaw of the profiling pliers and crimp down. Repeat until the end of the belt is reached.

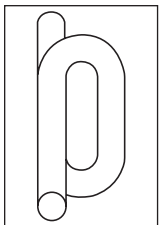
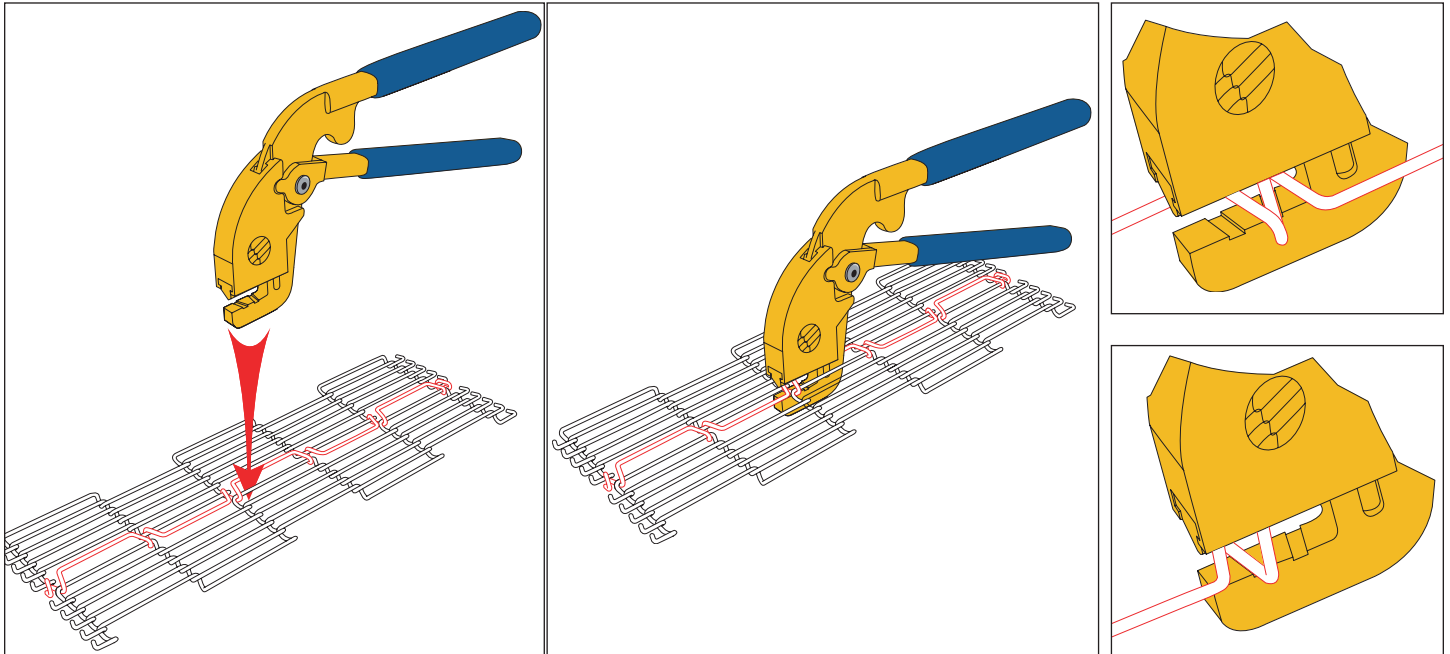

Z-bend uncrimped

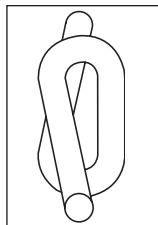

Z-bend crimped

Crimp the Z-bends in the splice strand to the proper profile height to insure required belt clearance throughout the conveyor circuit. Profiling Pliers will bottom out when Z-bend is fully crimped.